

4/12/24

Section 4 / Glass Room & Hallway
Boyer Heritage Center

PRODUCTION COST ESTIMATION 4

<u>Line</u>	<u>Agent</u>	<u>Estimator</u>	<u>Amount</u>	<u>Notes</u>
Exhibit fabrication	Spaces to Experiences	Jerry Knapp	\$33,000.00	Fabrication / installation / mounts, "barn door" entry, lathe panels, graphic stands, graphic structures, segmented banners, graphic panels w/cleat frames, various used firehose and nozzles, vitrine pedestal, wainscoting, collection pegboard, "fire" lighting in hallway, "spark" LED lighting behind lathe in hallway, mega graphic in window segments, mega graphic in south window, motion sensors in hallway and Glass Room, wireless audio in hallway and Glass Room, ribbon stanchions
Exhibit fabrication	Spaces to Experiences	Jerry Knapp	\$ 5,000.00	Estimated cost of added elements – one more display in northeast corner of Glass Room (2 lathe panels, 2 graphic panels), mirror panel over ramp, children's dress-up display
Track lighting	Halo		\$ 300.00	"Wild card" lengths of light track, fixtures
Painting		Mike LeMay	\$ 250.00	Painting in hallway and Glass Room
Electrical	Hark Electric		\$ 2,800.00	Track lighting, junction box, move pendant lights, add "EXIT" sign
SUBTOTAL			\$ 41,350.00	
5% Contingency			\$ 2,067.50	
NET TOTAL			\$ 43,417.50	

4/13/24

Section 4 / Glass Room & Hallway
 Boyne Heritage Center

GRAPHIC ELEMENTS

<u>Code</u>	<u>Size</u>	<u>Type</u>	<u>Presentation</u>	<u>Notes</u>
4g1	7' x 4'	Interpretive	Panel on lathe	<u>Summary of fires and tower clock</u> , within entry behind "barn door," overall title
4g2	7' x 28"	Interpretive	Panel on lathe	<u>Fire in mills experience</u> , historical turning point, at north end of hallway
4g3	7' x 24"	Interpretive	Panel on lathe	<u>Fire in town experience</u> , at north end of hallway
4g4-a-c	7' x 97" total	Mega-graphic	Segmented banners	Banner series along west wall, near ramp
4g5-a-f	7' x 17' 2.5" total	Mega-graphic	Segmented banners	Banner series along north wall, over ramp
4g6	24" x 24"	Interpretive	Panel on angle	<u>Tower Clock</u> , parts and operations, "Beating Heart"
4g7	18" x 24"	Interpretive	Panel on angle	<u>Tower Clock</u> , manufacturer
4g8	18" x 24"	Interpretive	Panel on angle	<u>Tower Clock</u> , restoration and re-installation
4g9	7' x 26"	Interpretive	Panel on lathe	<u>Tower Clock</u> , main thematic panel, role in community, staffing
4g10	(2) 8' x 11" x 4'8 1/2"	Mega-graphic	Transparent film	Set into two panes of window on south side of Glass Room
4g11	7' x 25 1/2"	Interpretive	Panel on lathe	<u>Fire Department</u> , main thematic panel, history
4g12	7' x 25 1/2"	Interpretive	Panel on lathe	<u>Fire Department</u> , operations, tools, safety

4913	18" x 24"	Interpretive	Panel on structure	<u>LaFrance</u> , preservation and conservation
4914	18" x 24"	Interpretive	Panel on structure	<u>LaFrance</u> , role in community
4915	18" x 24"	Interpretive	Panel on structure	<u>LaFrance</u> , parts and operations
4916	18" x 24"	Interpretive	Panel on structure	<u>LaFrance</u> , parts and operations
4917	7'5" x 13'	Mega-graphic	Perforated graphic	Set into 7 segments of windows and door

"Boyne Before Us" Exhibits
Boyne Heritage Center

P L A N 9 Glass Room
Graphic Elements

Date: 3/24/24
 Drawn by: Hines, PAJ
 Scale: 3/16" = 1'

- Panel on lath
direct print to 1/4" shtira, with cleat frame on back
- Segmented fabric mural
vertical banners with pole pockets
- Panel on frame
direct print to 1/4" shtira, mounted to structure
- Transparent photo mural
to be set into two panes of window
- Perforated graphic
secured to framed window segments and door.

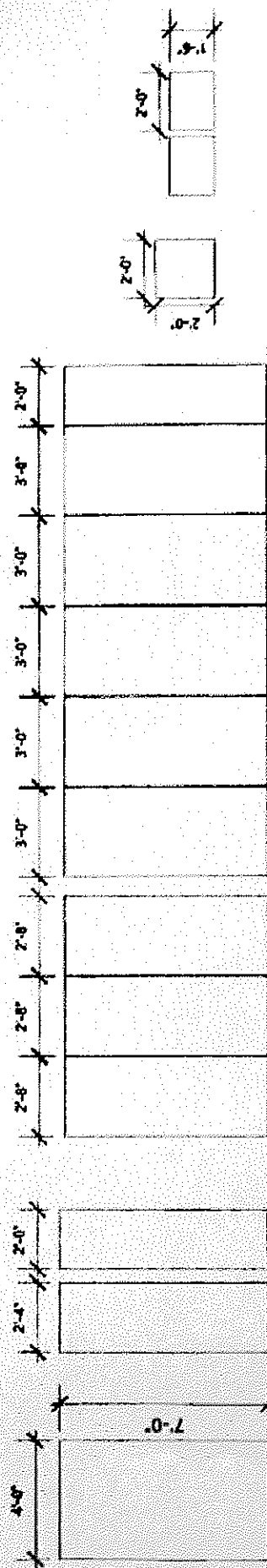

4g1
Panel on lath

4g2-3
Panels on lath

4g4a-c
Segmented fabric mural

4g5e-f
Segmented fabric mural

4g6
Angle panel on deck

4g7-8
Angle panels on deck

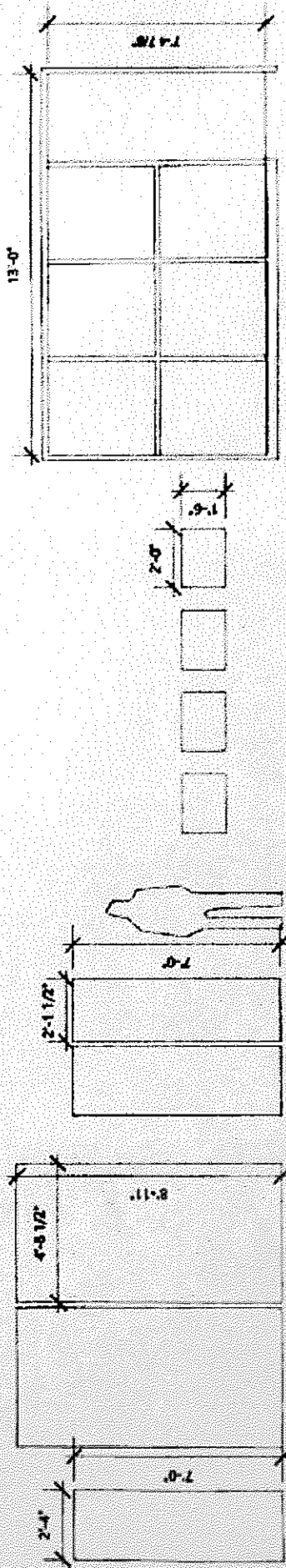

4g9
Panel on lath

4g10
Transparent photo mural (2 segments)

4g11&12
Panels on lath

4g13-16
Angle panels on stands

4g17
Perforated graphic spanning windows and door

Boyme Heritage Center
Boyme City, Michigan

PLAN 9 Glass Room
Graphics Perspective 1

Date: 3/13/24

Drawn by: Hines, PAJ

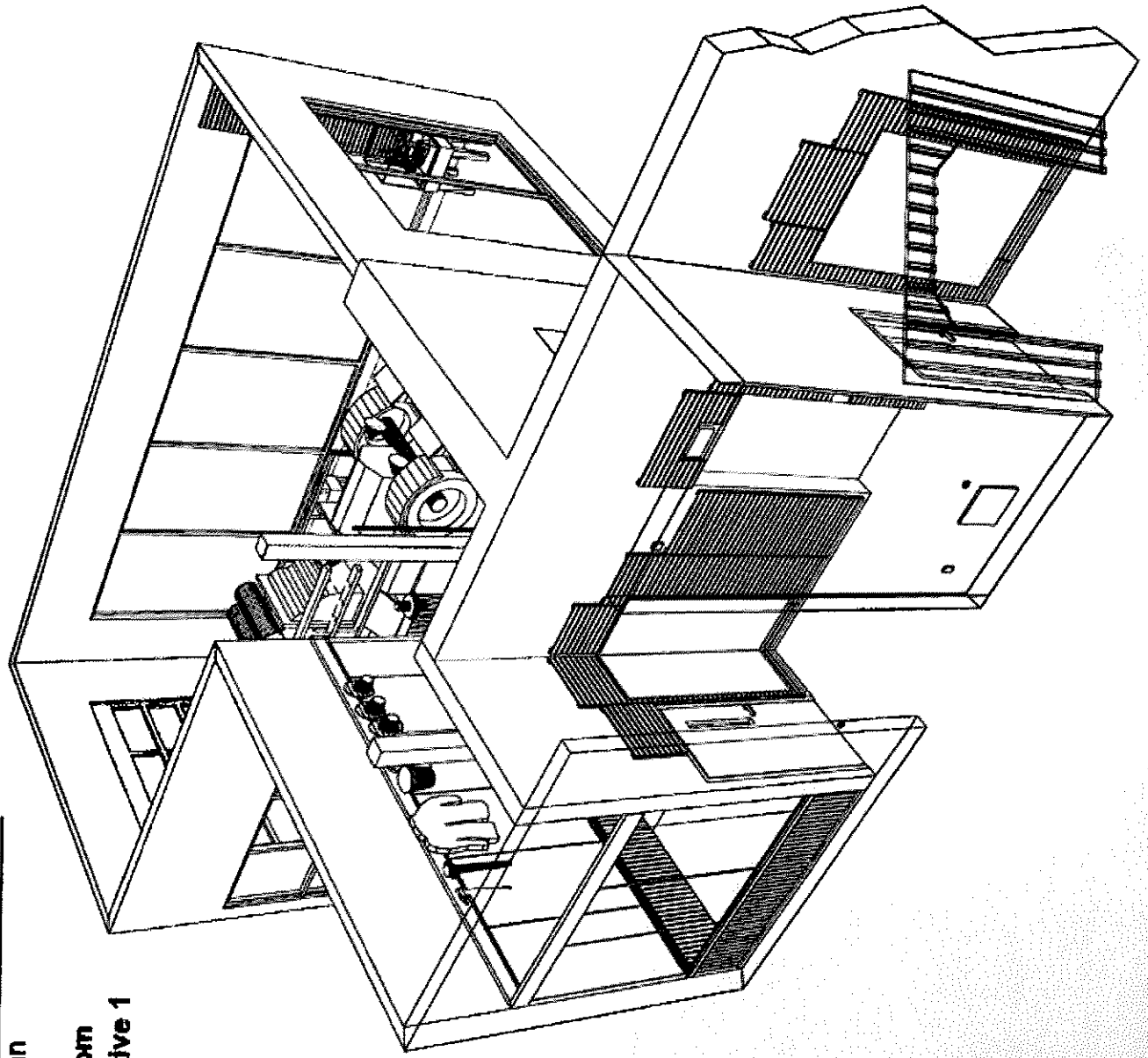

Boyer Heritage Center
Boyer City, Michigan

PLAN 9 Glass Room
Graphics Perspective 2

Date: 3/13/24

Drawn by: Hines, PAJ

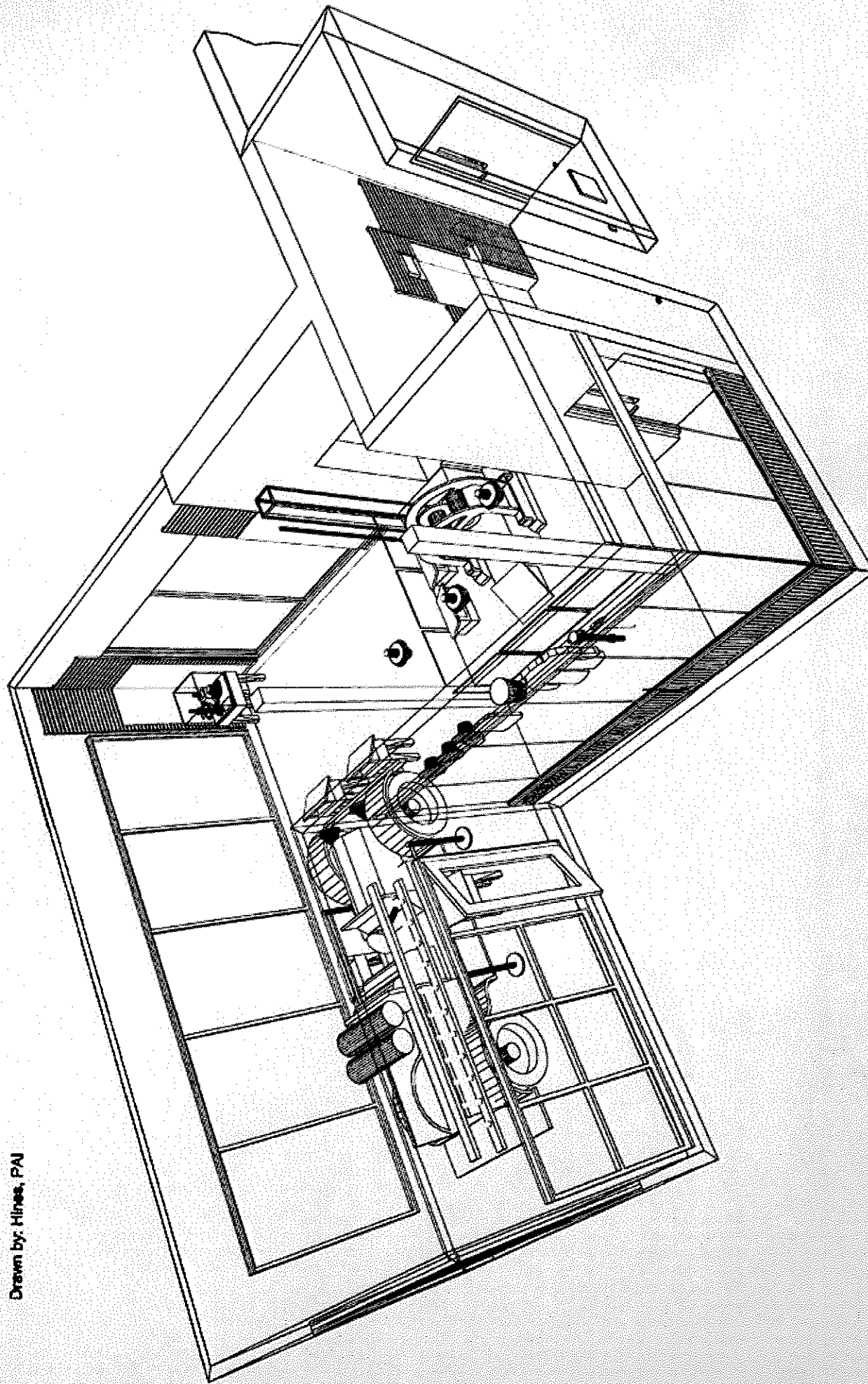

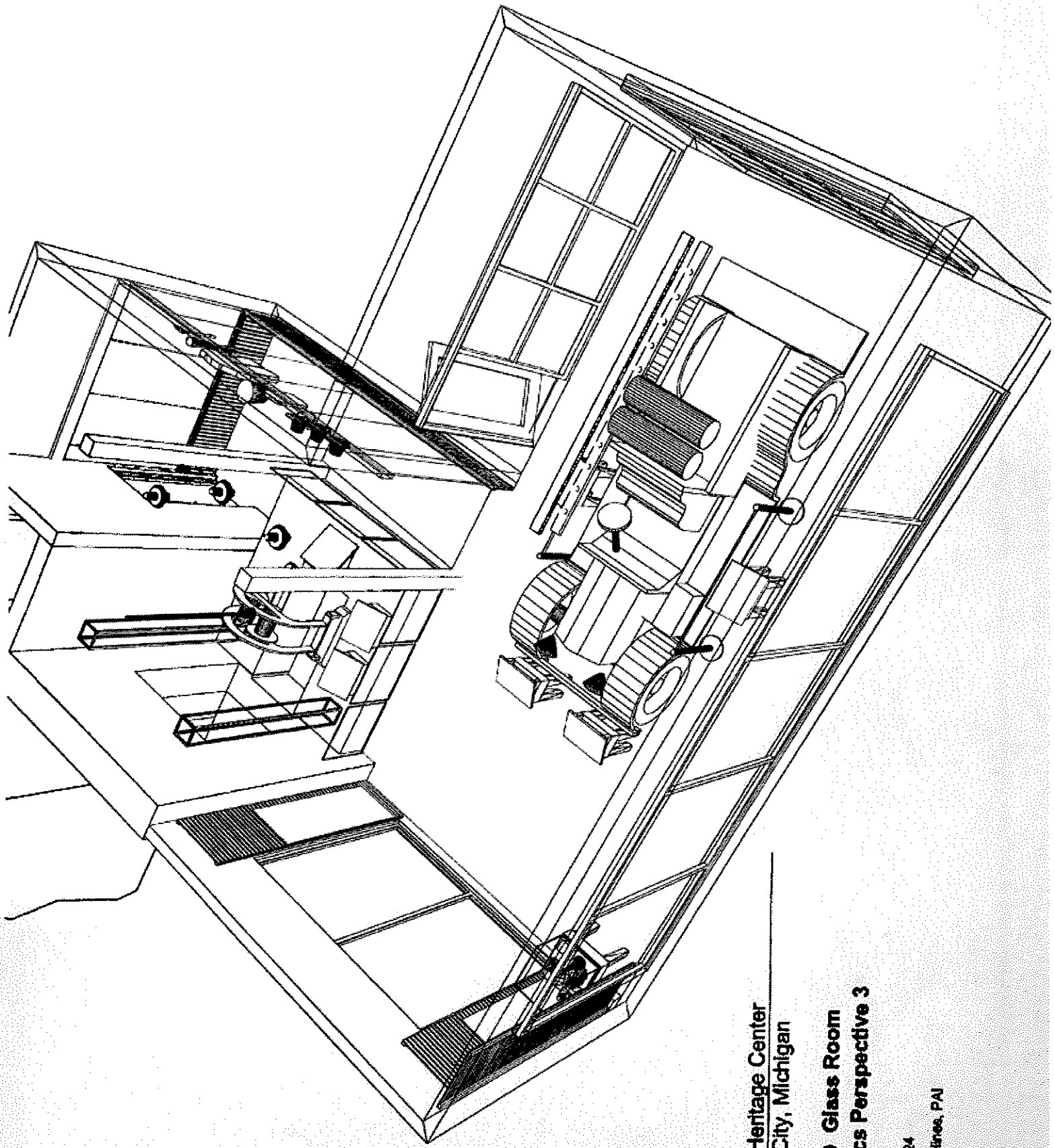

Boyme Heritage Center
Boyme City, Michigan

**PLAN 9 Glass Room
Graphics Perspective 3**

Date: 3/13/24

Drawn by: Hines, PAI

"Boyne Before Us" Exhibits
Boyne Heritage Center

PLAN 9 Glass Room
Graphic Plan

Date: 4/13/24
 Drawn by: Hines, PAI
 Scale: 1/8" = 1'

UP IS NORTH

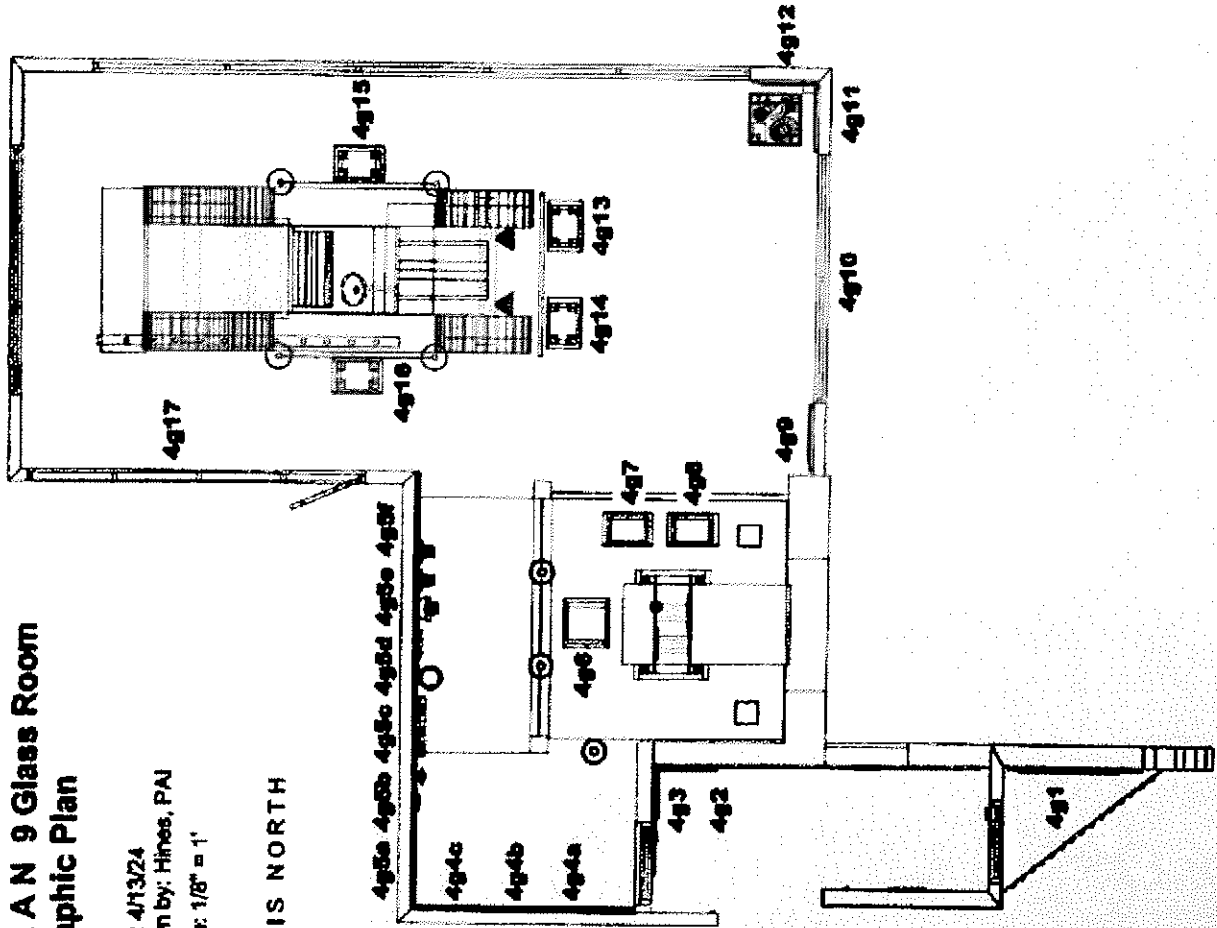

STORYLINE

- 4g1 panel on lathe
Historic fires and tower clock, early fire department, history-changing fire events in Boyne City
- 4g2-3 panels on lathe
Lumber mill fires, historical turning point, fires in community
- 4g4a-c segmented mural
Images of fire department, tower clock, fire scenes
- 4g5a-f segmented mural
Fire department in the community, tools, ID for collections over head, fire scenes
- 4g6 angle panel on deck
Tower clock, operations and parts
- 4g7 angle panel on deck
Tower clock manufacturer
- 4g8 angle panel on deck
Restoration of the tower clock
- 4g9 panel on lathe
Tower clock in the community, staffing
- 4g10 transparent photo mural (2 segments)
Historic photo
- 4g11-12 panels on lathe
Main fire department thematic panel, operations, tools, safety
- 4g13 angle panel on stand
LaFrance in the community
- 4g14 angle panel on stand
LaFrance features
- 4g15 angle panel on stand
LaFrance features
- 4g16 angle panel on stand
Preserving and maintaining the LaFrance
- 4g17 perforated photographic spanning framed windows & door
Historic photo